

INSTALLATION INSTRUCTIONS

BARRIBOARD™

Less noise, less cost!

What you need

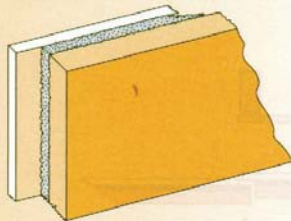

Barriboard™ panels

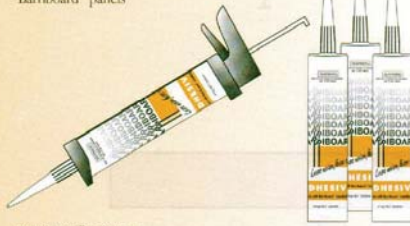

Barriboard™ adhesive

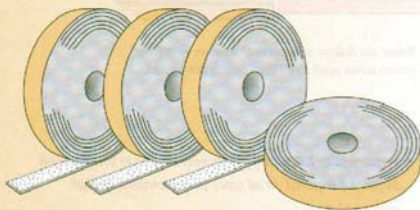

Barriseal™ floor seal



50mm screws

How to install

STEP 1

Starting from an internal corner, clean floor of all loose material where Barriboard™ panels are to be fitted.

STEP 2

Apply Barriseal™ floor seal tape in position on floor so it provides a seal under the 16mm section of Barriboard™ panels. Press Barriseal™ firmly into contact with floor.

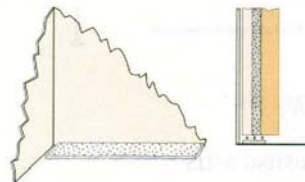

STEP 3

For first panel to be fixed, trim overlap off 16mm section of Barriboard™ so it is level with 10mm section. Install trimmed edge of panel facing into the internal corner.

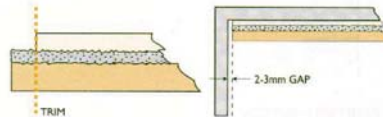

NOTES

1. Barriboard™ panels achieve full performance through overlapping and are designed to be installed vertically. If you wish to install them horizontally, a rebate must be cut at each end of the panel to the same depth as the existing overlap on the sides.
2. Leave a small gap 2-3 mm between the Barriboard™ panel and the walls and ceiling. This gap must be later sealed with an appropriate sealant (such as silicone or similar) to ensure noise transfer is minimised.

STEP 4

To fix panels in place, use the appropriate method overlap

