

Barrierboard

INSTALLATION INSTRUCTIONS

WHAT YOU NEED

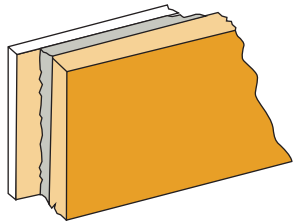

Barrierboard™ Panels

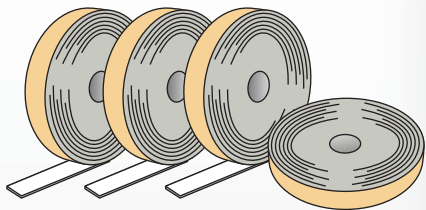

Barriseal™ Floor Seal

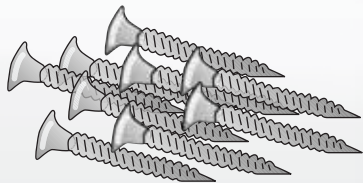

50-60mm Screws

HOW TO INSTALL

Step 1: Starting from an internal corner, clean floor of all loose material where Barrierboard™ panels are to be fitted.

Step 2: Apply Barrierboard™ floor seal tape in position on floor so it provides a seal under the rear 16mm section of Barrierboard™ panels. Press Barriseal™ firmly into contact with the floor.

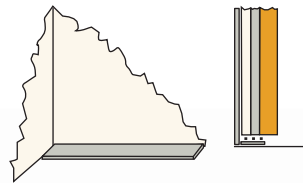

Step 3: For first panel to be fixed, trim overlap of 16mm section of the Barrierboard™ so it is level with 10mm section. Install trimmed edge of panel facing into the internal corner.

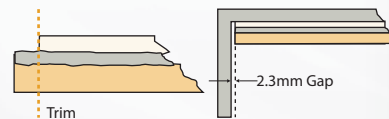

Notes

1. Barrierboard™ panels achieve full performance through overlapping and are designed to be installed vertically. If you wish to install them horizontally, a rebate must be cut at each end of the panel to the same depth as the existing overlap on the sides.
2. Leave a small 2-3mm gap between the Barrierboard™ panel and the walls and ceiling. This gap must be later sealed with an appropriate sealant (such as silicone or similar) to ensure noise transfer is minimised.

TIMBER OR METAL STUD WALL

NEW WALL

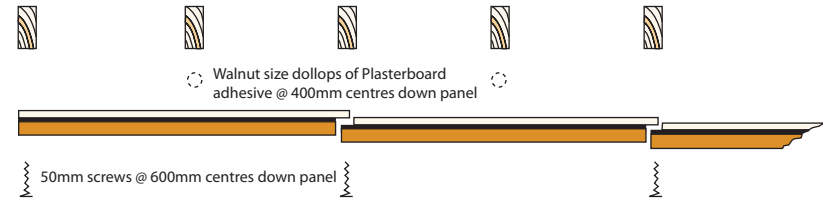

EXISTING WALL WITH PLASTERBOARD LINING

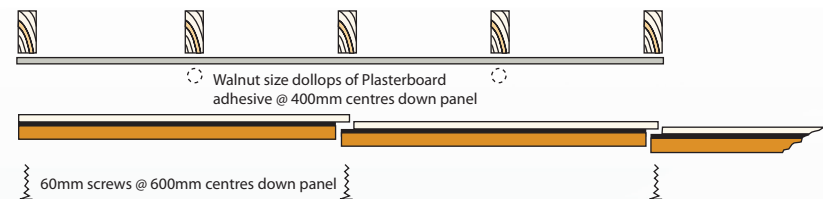

SOLID WALLS

NEW AND EXISTING WALLS

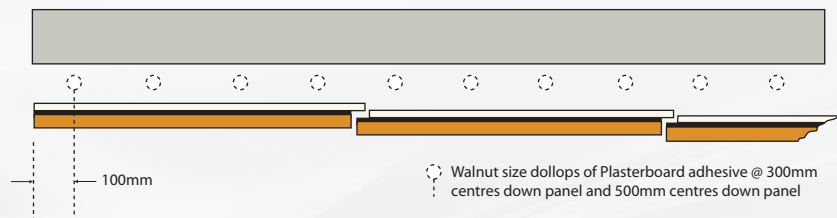

Important Notes

- If electrical or plumbing fixtures or fittings are to be moved, used a qualified tradesperson.
- All existing surfaces (whether painted, rendered or otherwise coated) should be free from loose materials and prepared by cleaning or scuffing all areas to be glued to ensure proper adhesion.
- Apply plasterboard adhesive in amounts and at spacings recommended above then gently press the Barrierboard™ panel onto wall in the correct position. Then peel back the panel for a few seconds to allow adhesive to go tacky before firmly pressing the panel back into place. Primary bonding should take place within 5 minutes.
- Permanent or temporary fixings may be used to hold the sheet in place if required. In all cases, avoid screwing through the silicone plugs.
- Finishing of walls and fixing of cornice, architraves, skirtings, etc. should be carried out as per normal methods. If your installation type is not covered in the above instructions, please contact us for more information.

Distributed by: **SOUNDBLOCK SOLUTIONS**

87 Epsom Rd Rosebery NSW • 9327 7410 • Fax 9327 1077 • enquiry@soundblock.com.au • www.soundblock.com.au